

求積表

地番	1 ①				
NO	Xn	Yn	Yn+1-Yn-1	Xn · (Yn+1-Yn-1)	
P-1	45971.454	-68056.375	-4.669	-214640.718726	
P-3	45970.883	-68062.397	-26.784	-1231284.130272	
P-13	45968.916	-68083.159	-21.174	-973345.827384	
B35	45971.346	-68083.571	-1.506	-69232.847076	
P23	45981.248	-68084.665	2.023	93020.064704	
P22	45981.795	-68081.548	13.783	633767.080485	
P21	45983.775	-68070.882	23.319	1072295.649225	
P20	45986.200	-68058.229	13.154	604902.474800	
P19	45985.884	-68057.728	1.854	85257.828936	
合計				739.574692	
合計面積				369.7873460	
地積				369.78 m ²	

地番	2 ②				
NO	Xn	Yn	Yn+1-Yn-1	Xn · (Yn+1-Yn-1)	
P-3	45970.883	-68062.397	21.954	1009244.765382	
P-4	45957.938	-68061.205	-18.720	-860332.599360	
P-12	45956.051	-68081.117	-20.317	-933689.088167	
B32	45959.052	-68081.522	-0.558	-25645.151016	
B33	45960.007	-68081.675	-0.250	-11490.001750	
KY6	45960.589	-68081.772	-1.254	-57634.578606	
B34	45967.556	-68082.929	-1.387	-63757.000172	
P-13	45968.916	-68083.159	20.532	943833.783312	
合計				530.129623	
合計面積				265.0648115	
地積				265.06 m ²	

地番	3 ③				
NO	Xn	Yn	Yn+1-Yn-1	Xn · (Yn+1-Yn-1)	
P-4	45957.938	-68061.205	20.171	927017.567398	
P-5	45955.118	-68060.946	-3.666	-168471.462588	
P-6	45945.001	-68064.871	-4.007	-184101.619007	
P-7	45944.524	-68064.953	-14.529	-667527.989196	
P-11	45943.156	-68079.400	-15.483	-711337.884348	
KY5	45950.937	-68080.436	-1.703	-78254.445711	
B31	45955.946	-68081.103	-0.681	-31295.999226	
P-12	45956.051	-68081.117	19.898	914433.502798	
合計				461.670120	
合計面積				230.8350600	
地積				230.83 m ²	

地番	4 ④				
NO	Xn	Yn	Yn+1-Yn-1	Xn · (Yn+1-Yn-1)	
P-7	45944.524	-68064.953	11.298	519081.232152	
P-8	45926.303	-68068.102	-7.513	-345044.314439	
P-10	45923.840	-68072.466	-11.108	-510122.014720	
BP2	45926.472	-68079.210	-6.834	-313861.509648	
P2	45941.735	-68079.300	-0.095	-4364.464825	
B30	45942.440	-68079.305	-0.100	-4594.244000	
P-11	45943.156	-68079.400	14.352	659376.174912	
合計				470.859432	
合計面積				235.4297160	
地積				235.42 m ²	

地番	5 道路				
NO	Xn	Yn	Yn+1-Yn-1	Xn · (Yn+1-Yn-1)	
P3	45918.034	-68060.053	-19.178	-880616.056052	
GD1	45925.283	-68079.203	-19.157	-879790.646431	
BP2	45926.472	-68079.210	6.737	309406.641864	
P-10	45923.840	-68072.466	11.108	510122.014720	
P-8	45926.303	-68068.102	7.513	345044.314439	
P-7	45944.524	-68064.953	3.231	148446.757044	
P-6	45945.001	-68064.871	4.007	184101.619007	
P-5	45955.118	-68060.946	3.666	168471.462588	
P-4	45957.938	-68061.205	-1.451	-66684.968038	
P-3	45970.883	-68062.397	4.830	222039.364890	
P-1	45971.454	-68056.375	6.076	279322.554504	
P18	45970.881	-68056.321	0.931	42798.890211	
P17	45961.354	-68055.444	1.525	70091.064850	
P-2	45954.354	-68054.796	-3.607	-165757.354878	
P5	45943.386	-68059.051	-7.712	-354315.392832	
P-9	45923.380	-68062.508	-0.970	-44545.678600	
BP1	45918.985	-68060.021	2.483	114016.839755	
P4	45918.895	-68060.025	-0.032	-1469.404640	
合計				682.022401	
合計面積				341.0112005	
地積				341.01 m ²	

地番	6 ⑤				
NO	Xn	Yn	Yn+1-Yn-1	Xn · (Yn+1-Yn-1)	
P5	45943.386	-68059.051	-0.097	-4456.508442	
P-2	45954.354	-68054.796	4.915	225865.649910	
P15	45947.232	-68054.136	0.443	20354.623776	
P14	45945.597	-68054.353	-0.563	-25867.371111	
P6	45943.220	-68054.699	-4.698	-215841.247560	
合計				55.146573	
合計面積				27.5732865	
地積				27.57 m ²	

地番	7 ⑥				
NO	Xn	Yn	Yn+1-Yn-1	Xn · (Yn+1-Yn-1)	
BP1	45918.985	-68060.021	-3.457	-158741.931145	
P-9	45923.380	-68062.508	0.970	44545.678600	
P5	45943.386	-68059.051	2.487	114261.200982	
合計				64.948437	
合計面積				32.4742185	
地積				32.47 m ²	

総合計面積 1502.1756390 m²

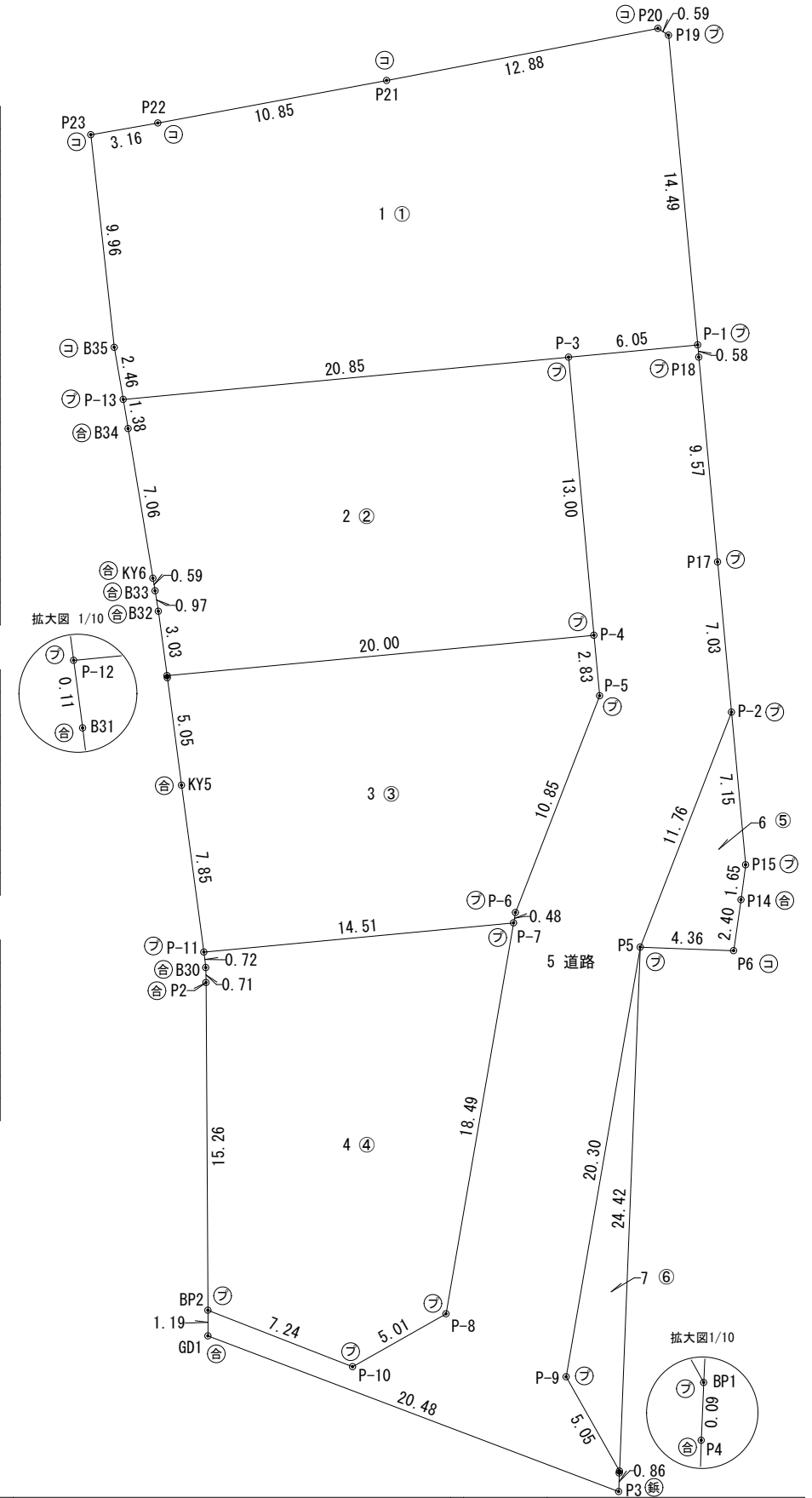

求積図	所在	前橋市北代田町字北261番1外	縮尺	1/300	作成者	高崎市上中居町43番地1 土地家屋調査士 須長 亮	作成年月日	令和5年9月11日
-----	----	-----------------	----	-------	-----	------------------------------	-------	-----------